

Manual Radon Scout Home

Thank you for the purchase of a Radon Scout Home. The instrument has been designed for long-term indoor measurements of the Radon concentration. The manufacturer cannot guarantee for damages that will result from use other than intended. Please read the manual carefully before operating the unit.

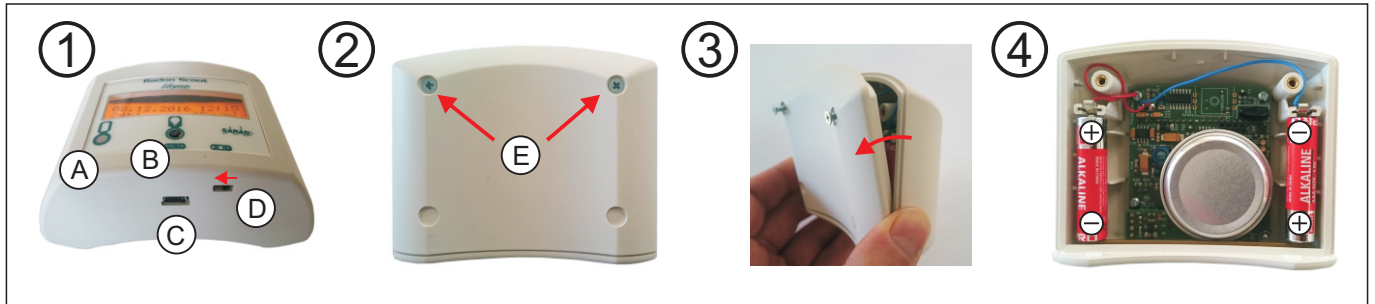

Inserting/replacing the batteries





Set the slide switch (D) into the left position (sampling stopped)

Unscrew both screws (E) at the rear of the instrument

Remove rear panel by slightly tilting on the upper rounding

Insert/replace the batteries (AAA/LR6) on the left and right (bottom first – check polarity)

Setting the clock (initial operation or after battery removal for longer periods)

Download the software Radon Vision and the USB driver from our website (www.sarad.de) and install both on your computer. Connect the USB cable to the PC and the USB interface (C) of the instrument. Start Radon Vision and click onto button  to obtain the COM port assigned to the unit. Open the setup dialog by clicking onto  button. Set clock using the  button. you will find the manual of Radon Vision on our website.

Sampling

Turn on the display by button (B) and set the slide switch (D) to the right. The first measured results will be presented after four hours (Avg = Average of the whole measurement, 24h = average of the last 24 hours). The display will alternate between temperature/humidity and Radon automatically. The unit records the readings every four-hours. When operated from battery, the display turns off after 30 seconds. Use button (B) to turn it on again. Another keystroke turns on the backlight. If Radon concentration exceeds 300Bq/m^3 , the red LED (A) starts blinking (four consecutive flashes each four seconds). To cancel a measurement, shift the slide switch (D) into the left position.

Hints for battery and mains power operation

The Radon Scout Home can be operated several months by battery. Here are some tips for a long-lasting battery operation:

- Use batteries of best quality brand that are especially optimized for long term use and low power consumption.
- Reduce usage of display and backlight.

In case of low battery the red indicator (A) starts blinking, one single flash each four seconds. The measurement continues for a few days but it is impossible to start a new measurement. **Remove discharged batteries immediately. Do not dispose batteries in domestic waste. You are legally obliged to return them to the appropriate waste collection centres.** The internal clock will be sustained for a couple of minutes during battery replacing. For mains power operation, use always a wall adapter with USB connector. Do not use the USB port of a computer for power supply.

Selection of the right place of measurement

Do not expose the instrument to permanent shocks or vibrations. Place the unit stationary in that room where you will stay most frequently. Avoid heat sources or radiofrequency emitting devices (e.g. mobile phones, microwave stoves, DECT phones or base stations) in the immediate surrounding of the instrument. The distance from the wall should be more than 25cm (10inches) because the wall itself could be the reason for an increased Radon concentration.

Further processing of measured results

Measured values of the previous eight years are stored in the instrument (circular memory structure). The measured data can be read through the USB port (C) and shown, exported or printed by Radon Vision. Refer software manual (SARAD website) to find out the complete functionality of Radon Vision.